

▶ PRIMUS HOTEL SYDNEY

In December 2015, one of Sydney's finest examples of art deco glamour opened its doors as the five star Primus Hotel Sydney. Perfectly positioned in the heart of the city, this heritage-sensitive refit of the former Sydney Water Board headquarters has breathed new life into an iconic 1930's building.

The hotel showcases a lobby bar, an adjoining all-day dining restaurant, rooftop pool and conferencing and event spaces underpinned by a modern design philosophy. The generously sized 172 rooms and suites feature lavish contemporary interiors that create an authentic and engaging experience for both leisure and corporate guests.

▶ FACILITIES

- ▲ 172 rooms and suites
- ▲ Complimentary WiFi
- ▲ All day dining at The Wilmot
- ▲ Lobby Bar
- ▲ Outdoor heated pool with sundeck
- ▲ Gymnasium
- ▲ Three dedicate boardrooms
- ▲ Conference and meeting rooms with natural light
- ▲ 24 hour room service
- ▲ Concierge
- ▲ Business centre
- ▲ Valet car parking



01

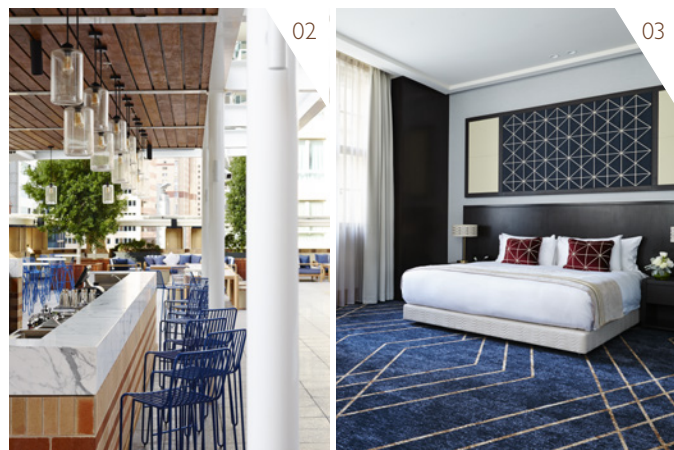

02

03

▶ ROOM TYPES

Each of our 172 rooms and suites are thoughtfully designed harmonising contemporary style and art deco design.

▲ Deluxe King and Twin

For work or play, the elegantly designed Deluxe King room is crafted to delight and charm and offers a king bed or two king single beds, 42 inch LED TV, iPod dock and chaise lounge. Complementing the living areas is a spacious bathroom featuring a walk in shower and Appelles amenities.

▲ Executive King and Twin

The lavish style and comfort of the Executive Rooms have been created with the sophisticated traveller in mind. Executive Rooms are flexibly furnished with one king bed or two king single beds in addition to the ample work desk and chair; Nespresso coffee maker and selection of teas. The truly relaxing experience is enhanced by a generous bathroom with a large soaking bath and walk in shower, nightly turndown service, luxurious bathrobes and slippers.

▲ Superior Suite

The Superior Suite is a fresh take on grand, apartment-styled living and designed for travellers who want the extra space. Along with a king bed, the separate sitting area is richly appointed with a plush sofa and large 55 inch LCD while the powder room and large soaking bath are blissful areas to retreat for rest and rejuvenation.

▲ Deluxe Suite

The grand proportions of the Deluxe Suites are designed with a nod to the building's fabulous art deco era while giving guests all that comes with world class accommodation inc. high speed internet and iPhone docking stations. Along with the king bed, separate sitting area and sofa, double vanity and large soaking bath, the suite's generous floor space brings a deep sense of tranquillity far from the bustle of the city below.

▲ Executive Suite

The Executive Suite offers a refined, residential-style space with stunning marble features and elegant furnishings. Appointed with a table that seats up to six guests. The free standing bath, walk in shower and double vanity complete the classic, stylish feel.

▲ Vice Presidential Suite

Relax in luxury or entertain in stylish comfort with the expansive, elegant spaces of the Vice Presidential Suite. Bathed in natural light, the combined living and dining room features a table for eight, as well as two sofas and comfortable arm chairs. A butler's pantry and powder room hark back to refined, old world charm while the oversized ensuite bathroom complete with a large soaking bath and walk in shower bookends the aesthetic.

▲ Presidential Suite

Our most spacious and well-appointed offering situated on the hotel's top floor. The opulent combined living and formal dining area set against city views is furnished with a 10 person dining table, sumptuous sofas and arm chairs as well as a modern butler kitchen, powder room and walk-in-wardrobe that will accommodate all your long and short-stay luggage needs. The separate bedroom features an ensuite with double vanity, walk-in shower and free standing bath for the pinnacle in relaxation

LOCATION

Located in the heart of Sydney's CBD on the famous Pitt Street, Primus Hotel Sydney is at the epicentre of entertainment, history and retail with the iconic Hyde Park, Town Hall, Queen Victoria Building, and St Mary's Cathedral at its doorstep.

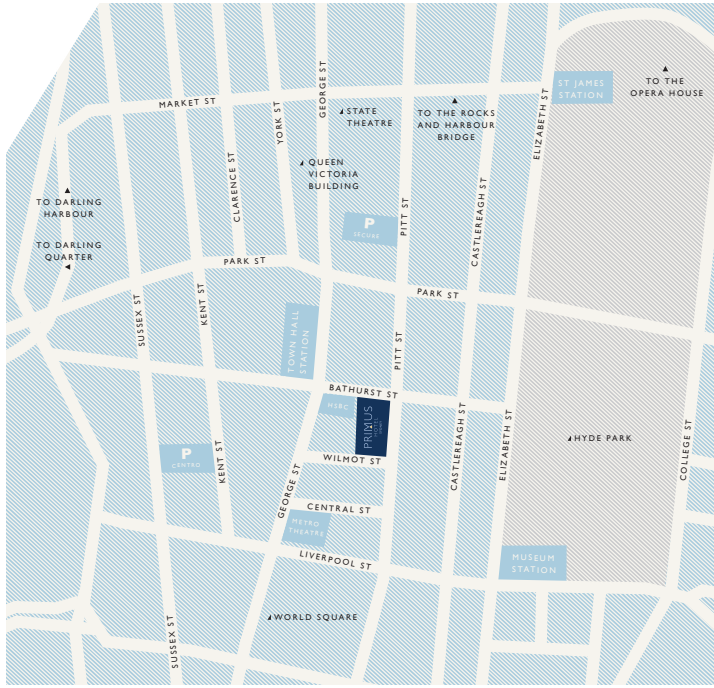

/ Sydney Location

THE WILMOT

Emerging and recently awarded Head Chef, Ryan Hong, brings refined contemporary cuisine with an Asian twist to the stunning art deco restaurant; The Wilmot. Witness modern gastronomy showcased in a dramatic show kitchen and enjoy cutting edge dishes made from the best local produce, married with textured flavours and regional influences.

LOBBY BAR

Bringing an unparalleled sense of grandeur to Sydney, The Lobby Bar is a stylish spot for intimate pre or post dinner drinks, attracting the who's who of Sydney and overseas. Respectful to the legacy of the building's history, the menu is refined, the service is polished and the atmosphere is representative of the grandest European and American Hotels.

MEETINGS AND EVENTS

True to its art deco heritage yet underpinned by a modern design philosophy, the functions and event floor of Primus Hotel Sydney has been spectacularly re-imagined. This contemporary and refined space features three functional meeting rooms and three splendid boardrooms all with natural light and free internet, unforgettable food and beverage experiences coupled with attentive and polished service. The ultimate combination to ensure memorable moments.

Soak in the atmosphere of Sydney from the New York style rooftop. Catering up to 240 people the area uses an intelligent use of green terracing, tonal blue finishes and indoor-outdoor spaces creating a truly unique outdoor venue perfect for pre-dinner drinks or an intimate cocktail function.

/ Capacity Chart

	AREA (m ²)	CEILING HEIGHT (m)	THEATRE	BANQUET	BOARD ROOM	COCKTAIL	CABARET	CLASSROOM	U-SHAPE
Meeting Room	344	3.1	290'	230'/200"/180"	•	290'	184	210	•
Meeting Room 1	154	3.1	90	80'/60"	30	120	72	46	30
Meeting Room 2	94	3.1	80	60'/50"	30	80	56	46	30
Meeting Room 3	96	3.1	80	60'/50"	30	80	56	46	30
Board Room 1	30	3.1	•	10	•	•	8	•	•
Board Room 2	78	3.1	30	30	24	40	24	24	16
Board Room 3	28	3.1	•	10	•	•	8	•	•
Rooftop	250	•	•	•	•	240	•	•	•
Lobby	234	8.0	•	200	•	350	•	•	•

* maximum capacity with round tables ** maximum capacity with stage and the use of the ceiling mounted screens *** maximum capacity with stage and dancefloor and the use of the ceiling mounted screens

/ Mezzanine level floorplan

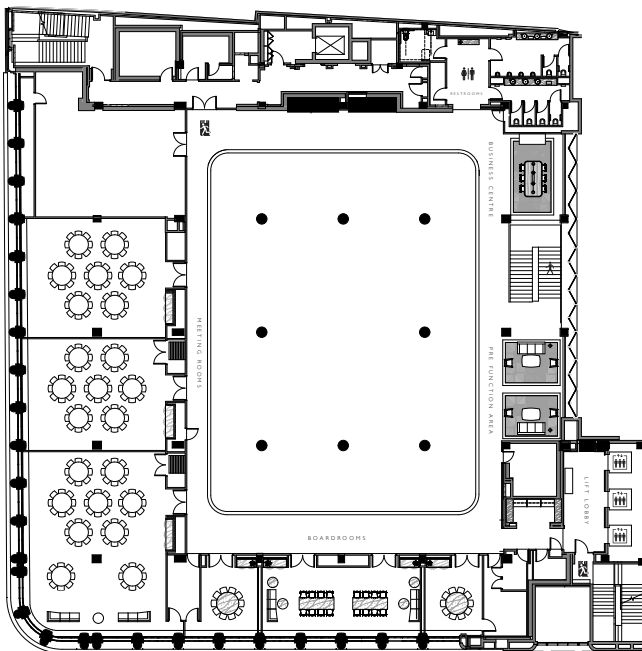

MEZZANINE LEVEL

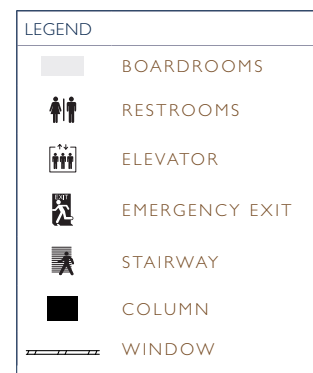

PRIMUS HOTEL SYDNEY
 339 Pitt Street Sydney
 NSW Australia 2000
 T +61 2 8027 8000
 F +61 2 8027 8099
 primushotelsydney.com